

Digital Caliper 16 EW according to protection class IP67



Features

Functions:



ON/OFF
0 (Zero setting)
mm/inch
Reference Lock
Unlock

- Inductive waterproof measuring system FPS (Fluid Protected measuring System) with Reference Lock Function
- Dirt wipers are integrated in the slide
- Life of the battery ca. 2 years

- Max measuring speed 1.5 m/sec (60"/sec)
- High contrast Liquid Crystal Display with 7.5 mm high digits
- Lapped guide way
- Slide and beam made of hardened stainless steel

- Measuring blades for inside measurement
- Step measuring function
- Locking screw
- Supplied with: Case, battery, operating instructions

Technical Data

Measuring range mm (inch)	Resolution mm/inch	Error limit G		Depth rod		Friction wheel	Order no.
		mm/inch	DIN 862				
150 (6")	0.01/ .0005"	0.03/ .0015"	●	●			4102900
150 (6")	0.01/ .0005"	0.03/ .0015"	●	●		●	4102901
150 (6")	0.01/ .0005"	0.03/ .0015"	●		●		4102911
150 (6")	0.01/ .0005"	0.03/ .0015"	●		●	●	4102912
200 (8")	0.01/ .0005"	0.03/ .0015"	●		●	●	4102902
200 (8")	0.01/ .0005"	0.03/ .0015"	●		●	●	4102903
300 (12")	0.01/ .0005"	0.04/ .0016"					4102906
300 (12")	0.01/ .0005"	0.04/ .0016"				●	4102907

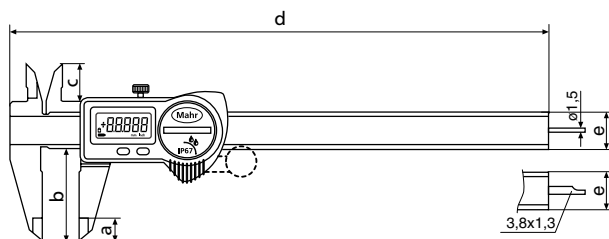

Dimensions

mm/ inch	a	b	c	d	e
150/ 6	10/ .4	40/ 1.6	16/ .6	233/ 9.2	16 x 3/ .6 x .12
200/ 8	10/ .4	40/ 1.6	16/ .6	285/ 11.2	16 x 3/ .6 x .12
300/ 12	14/ .5	64/ 2.5	18/ .7	388/ 15.2	16 x 4/ .6 x .15

Accessories

	Order no.
Depth Measuring Bridge	16 Em 4102020
Battery 3V, Type CR 2032	4102520

16 Em

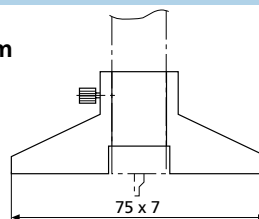

MarCal. Calipers

► I The water proof digital caliper **MarCal 16 EW**, is now available with the protection class IP67. Even in the most difficult workshop conditions, precise and reliable results are assured.

Both the housing and operating buttons are made from Ultradur®, which has an excellent chemical resistance

Lapped guide ways allow smooth and even movement

Large display with 7.5 mm high numerals

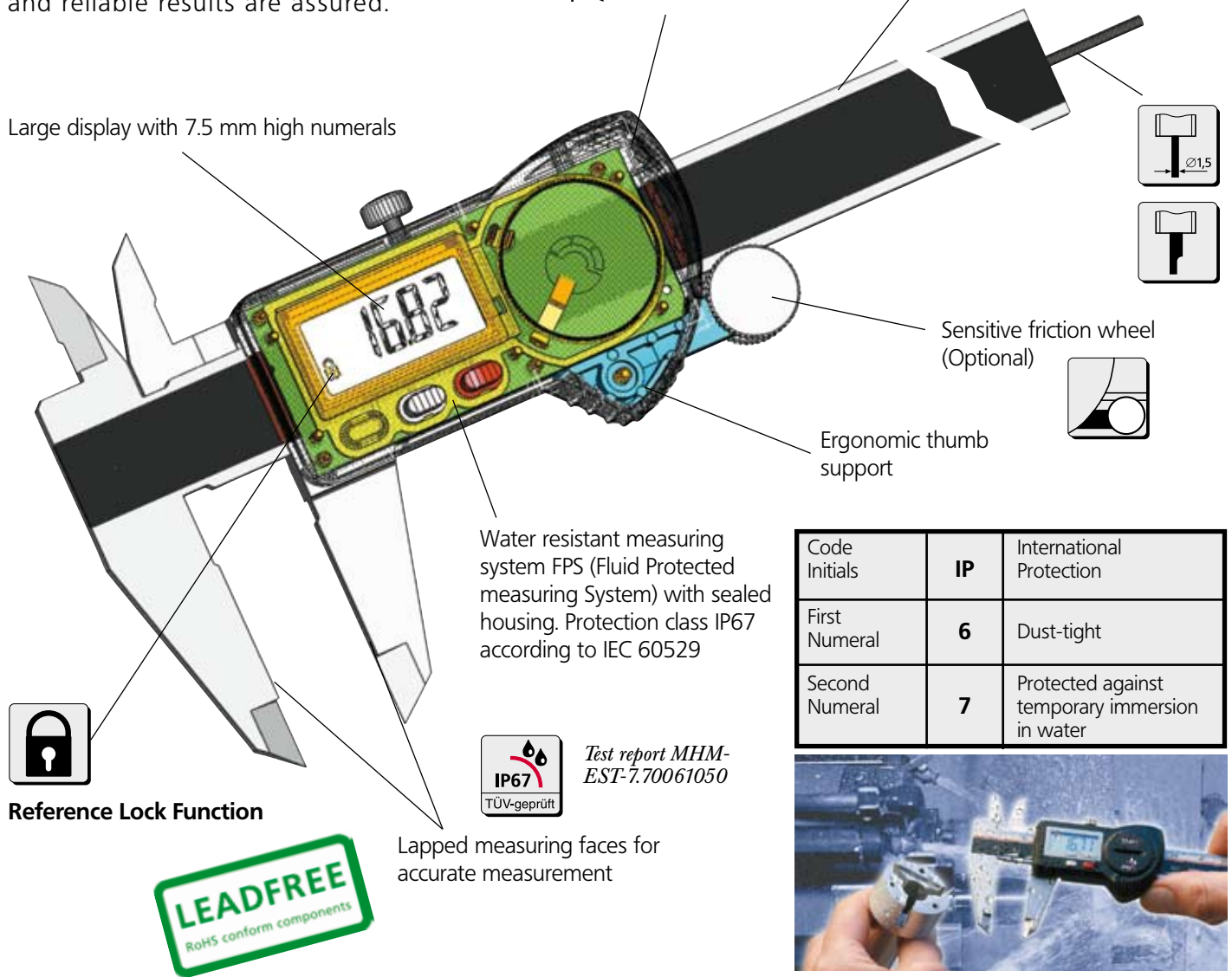

Code Initials	IP	International Protection
First Numeral	6	Dust-tight
Second Numeral	7	Protected against temporary immersion in water



Reference Lock Function

1. First set to zero

2. Lock-Function is activated

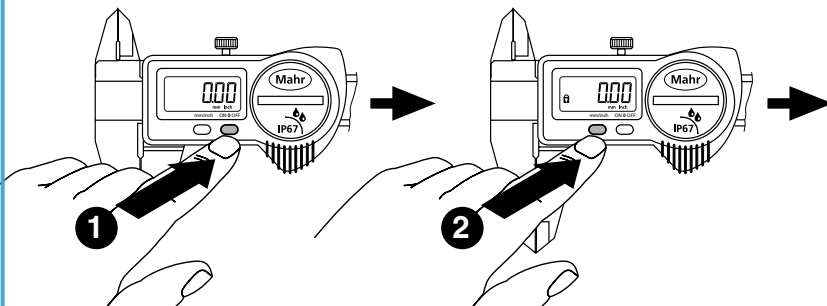

Advantages of the Reference Lock Function

- Zero position is secured
- Operating error is prevented
- Caliper is always ready for measurement