

# MANUAL vices for 5-axis machining centres

## Arnold SELF-CENTRING SC

ARNOLD SC High Precision vices are compact, high and self-centring and maintain constant length, which makes them specially valid for working in 5 - axis machining centres.

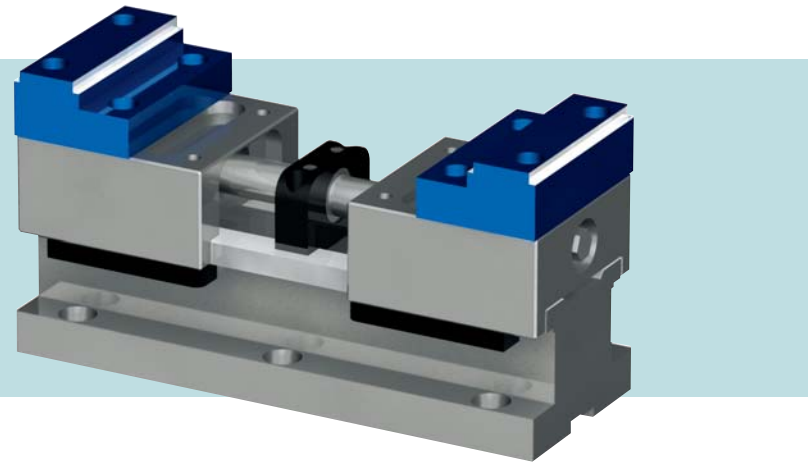

- Self-centring high precision vices.
- 0.01 mm clamping repeatability.
- 0.02/0.03 mm accuracy on centring.
- Designed to work on machining centres with small tables and in 5-axis controlled centres.
- Compact design with exterior guides that avoids deformation as the clamping force is distributed throughout the width.
- Clamping force from 2 to 4 tons, in accordance with the clamping torque applied.
- Threaded right-left spindle, which can be operated with standard key.

### These vices have a clamp casing system

- The force is applied as near as possible to the piece to be machined. This means that the torque power is used to the full.

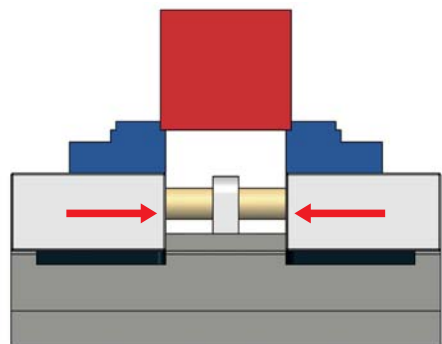

Interchangeable jaws can reach a height of 125 mm, this means they can overcome the biggest obstacle for this type of work; avoiding collisions with the machine turrets or the rotation of the table.

### Clamping possibilities

Possibility of positioning the jaws in two locations. Possibility of positioning the jaws in two positions rotating them on their axis.

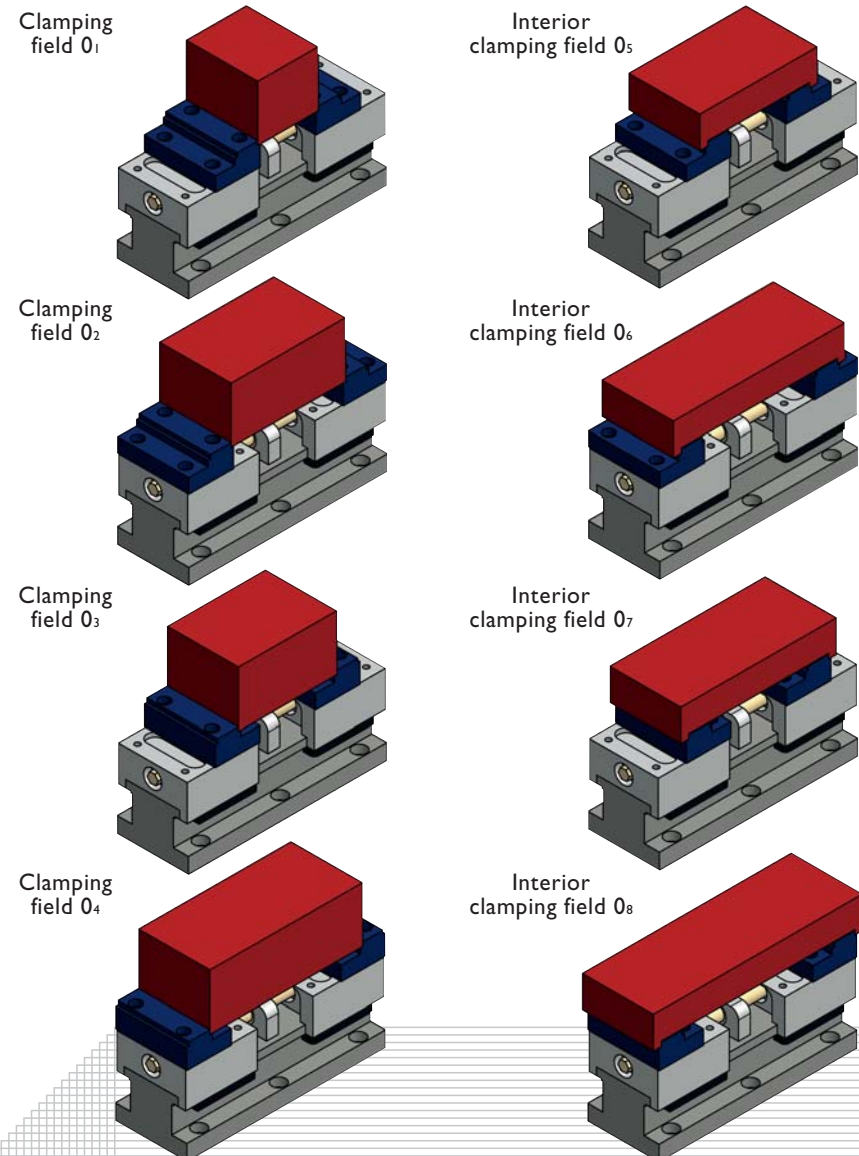

Size	090	125
Arnold SC	050 200 090	050 200 125
A	250	350
B	115	165
C	20H7	20H7
D	100	103
E	125	125
F	90	125
G	30	30
H	5	5
I	3	4
J	91	126
Weight (kg)	14,3 kg	30 kg
Clamping field 0 <sub>1</sub>	12 - 76	14 - 108
Clamping field 0 <sub>2</sub>	80 - 144	104 - 198
Clamping field 0 <sub>3</sub>	60 - 124	84 - 178
Clamping field 0 <sub>4</sub>	129 - 192	174 - 268
Clamping field 0 <sub>5</sub>	64 - 128	82 - 176
Clamping field 0 <sub>6</sub>	132 - 196	172 - 266
Clamping field 0 <sub>7</sub>	112 - 176	152 - 246
Clamping field 0 <sub>8</sub>	180 - 238	242 - 336

The clamping force depends on the torque applied to the handle.

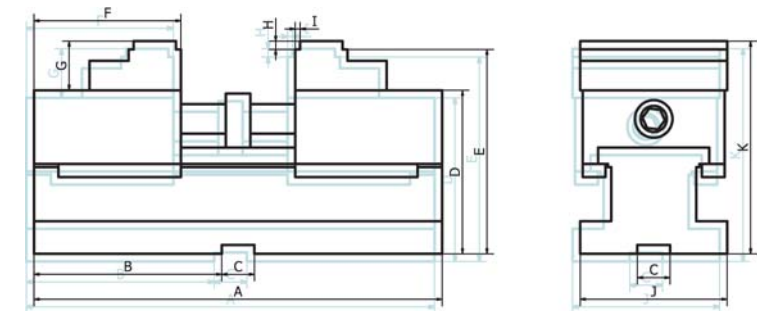

### Set supplied

- base body
- mechanical spindle without high pressure
- 1 set of jaws
- 1 handle
- 4 end clamps
- instruction manual

